

- 3) Next, using a timing light, check that the arrow mark on the timing plate points to 25 ± 1 deg. ($24^\circ \sim 28^\circ$), with the magneto control lever ① held in contact with the fully-advanced stopper ②.

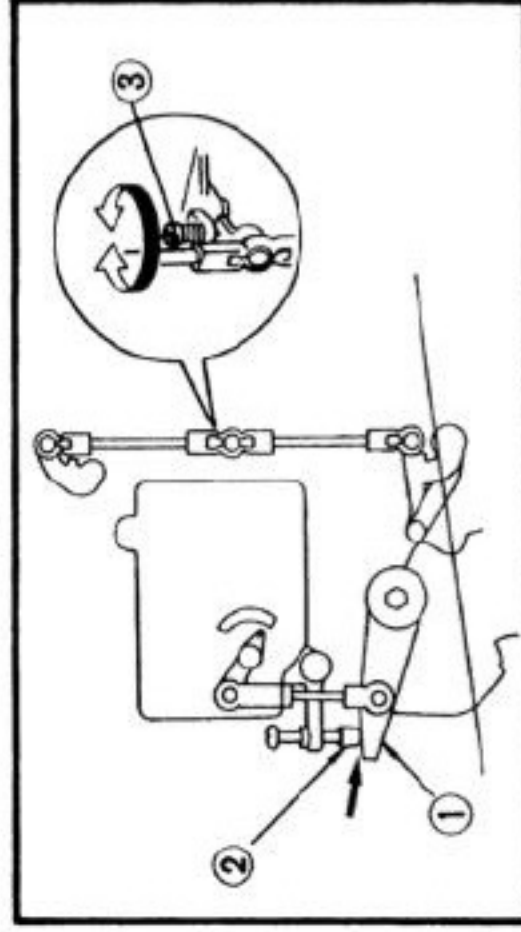

- 4) With the magneto control lever ① held in contact with the fully-closed stopper screw ②, adjust the carburetor idle adjust screw ③ so that the engine idles at 800 ± 50 rpm.



Idle speed: 800 ± 50 r/min

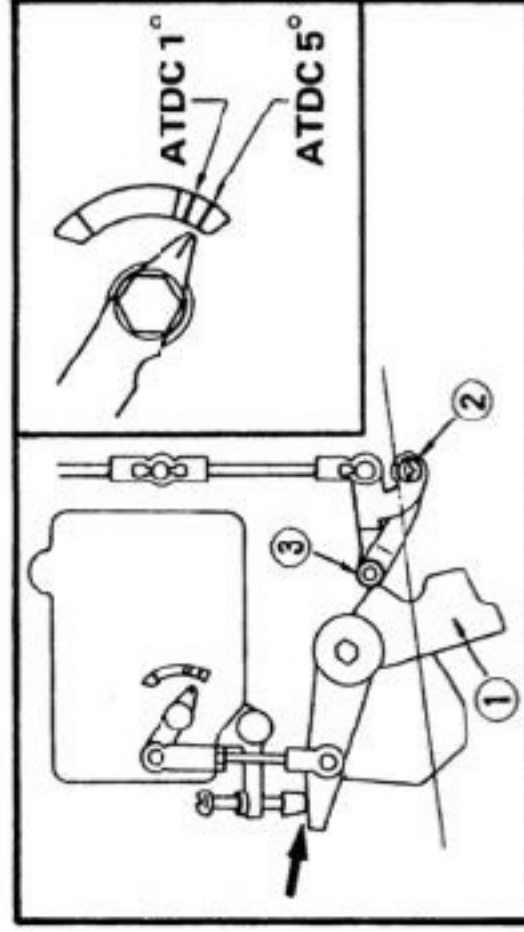

- 5) Adjust the position of the throttle valve roller ③ by turning the adjust screw (left-hand) ② in and out so that when the accelerator cam ① turns, the throttle valve starts to operate at the following specified timing.



Pick up timing:
40hp: ATDC $5^\circ \pm 1^\circ$
50hp: ATDC $1^\circ \pm 1^\circ$